

## 01 Installation

Installing the adapter and the bulb.  
Insert the adapter into the suited slot of Mi router.

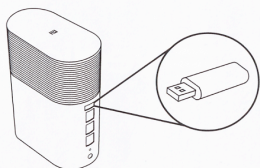

\* Mi router also supports other official devices.

## 02

Bulb installation  
Screw the bulb, turn on the power switch

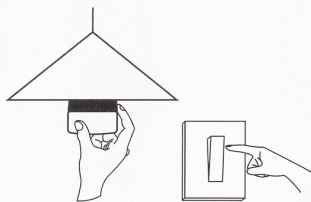

## 03 APP Control

Download and install Mi APP, in the list of smart devices you will find an installed bulb.  
If after installing the bulb it does not appear on the list of mobile application, try to restore to factory settings

\* Make sure that your phone is connected to WIFI and to Mi router.

### Restore bulb to factory setting

Keep your bulb on for at least 30s, then turn it off, now you can do the restore operation as following steps:

- 1) Turn bulb on, when it's up and shows maximum white light, turn off immediately (less than 5 seconds);
- 2) Repeat above step for 3 times;
- 3) Then turn on the bulb again, you could see bulb shows red/green/blue/white, it means the operation is successful.

### Caution

- \*Please confirm the power voltage before installation, incompatible voltage may cause safety issue;
- \* Do NOT teardown product;
- \* Because of the heat given by LEDs, please install the bulb in free air, make sure there is no enclosure to trap heat.

## List of components

LED Bulb x1  
USB Adapter x1  
(Packed separately)  
Warranty x1  
User manual x1

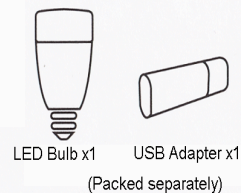

### Specifications

Specifications	
Lighting output	White and RGB
Voltage	100~240V 50/60Hz
Wattage	6 Watt
Standby Wattage	Less than 0.3 Watt
Bulb Base	E27 (according to the standards of the product)

## Product Structure

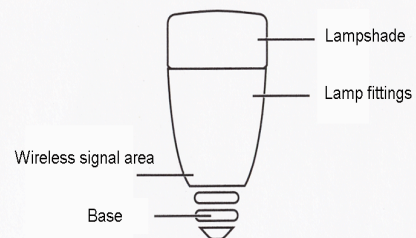

## Yeelight warranty

Number  
Date of purchase (Date of sell)  
Seller

Customer name  
Address

Contact number

Thank you for purchasing this product.  
Warranty period - 12 months from the date of purchase.  
Be sure to fill in the data in the warranty card that you can use in case of a warranty repair.

XIAOMI-MI.COM