

# Mi Box 3

## Accessories

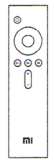

Mi Box



Remote control

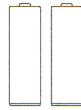

Batteries x2



Remote control strap

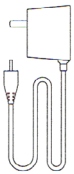

Power adapter

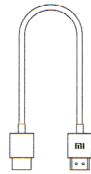

HDMI cable for HD video

## Installation

### 1. Connect to TV

We recommend to connect Mi Box to the TV via HDMI cable to view HD videos.

### 2. Switch up

After switching up a power, indicator of Mi Box lights up

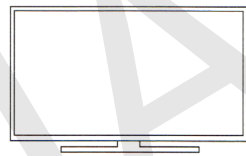

电视

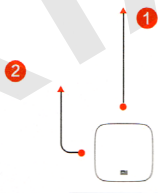

## Mi Box interface

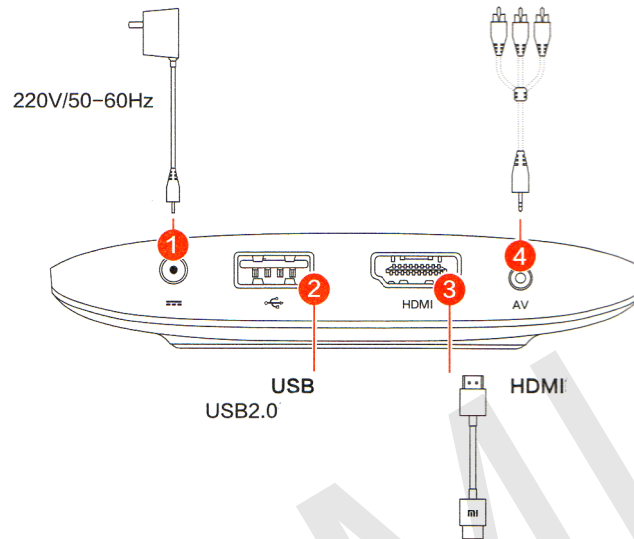

## TV set

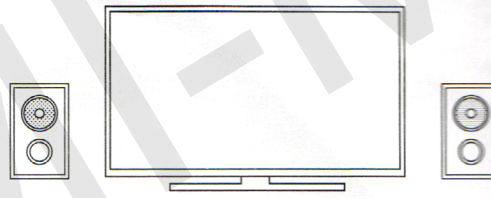

Make a home theater by your TV using HDMI cable.

## Connecting an amplifier

### 1. Connecting power amplifier to a TV

Use an HDMI cable to connect the amplifier to a TV.

### 2. Connect Mi Box to an amplifier

Connect Mi Box to an amplifier by HDMI cable to output sound to the speakers.

### 3. Connect speakers to an amplifier

Connect speakers by its cable to an amplifier. Build your home theater.

### 4. Switching on

Once all devices are connected to each other, switch on a power.

## Remote control

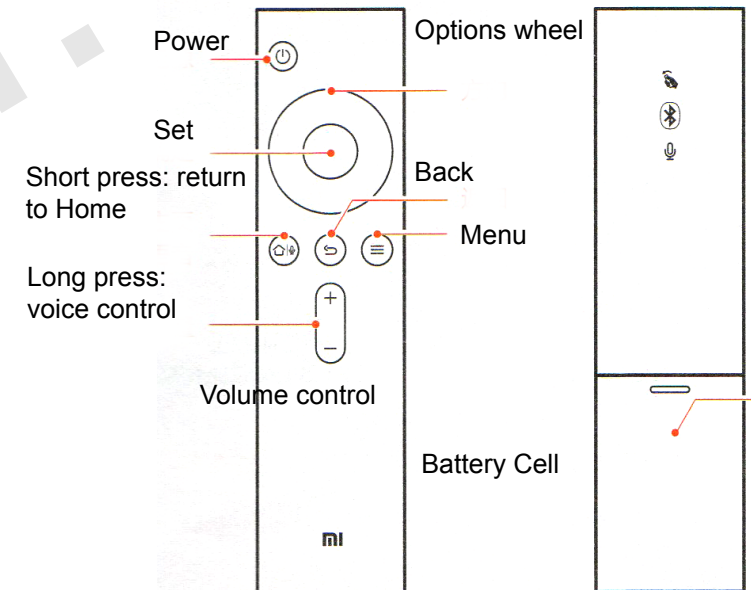

**Home:** fast return to home page

**Menu:** using of interface and various functions  
For example: a home page, search for what you want to watch, choice selection of videos; more categories and different functions in the interface.

## Remote control

**Choice and different options:** management focus (up, down, left, right). When you watching a video, right and left choice allow fast-forward or rewind. Confirm selection: press the button to confirm your choice;

**Return:** Return one step back

**Press «Menu» and «Home» to start pairing to TV via Bluetooth.**

## Using the remote control strap

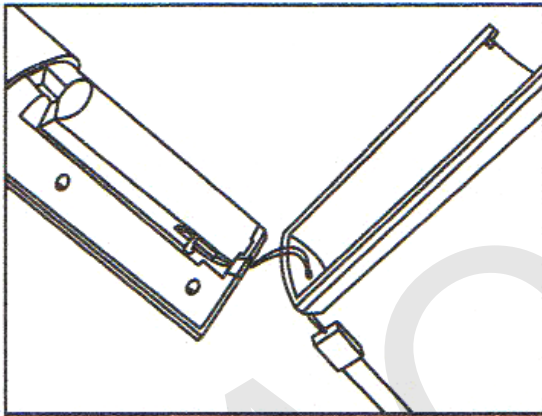

1. Pull the strap loop through the hole at the bottom of a battery compartment;
2. Once you pulled loop strap through the hole at the bottom of a battery compartment, slide it through the latch between two batteries;
3. Insert batteries, and close a back cover of a battery compartment.

## Broadcasting video to the screen



### Broadcasting photos, videos

You can easily view photos and videos that are stored on your phone, on the big screen, with Mi Box. Enjoy viewing files with your family.

### Using

Using your phone to control your TV - it is a fun, simple and easy thing.

### Remote control

Freed «shackles» of the traditional remote control, you can easily manage Mi Box on your phone.

**To install the program «Broadcasting on screen» to phone, scan the QR-code**

## Warranty

During the warranty period you have the right to repair, replace or return the product. For repair, replacement or return of goods, you must have a receipt.

1. In a current 7 days of purchase, in the event of problems with Mi Box, a buyer is entitled to a one-time free replacement product of the same model or refund.
2. Within 15 days of purchase, in the event of problems with Mi Box, a buyer is entitled to a one-time free replacement product of the same model.
3. During the 12 months of purchase, if there is a problem with Mi Box, a buyer has the right to free repair device.

## Notice

The following conditions, which are not included in the warranty service:

- Damage, caused by using the device for other purposes, improper care, or improper maintenance;
- Warranty period has expired;
- Damage, arising under force majeure, such as lightning, fire or flood;
- Problems, arising from maintenance service centers of other brand.